

## DS Creator 2.0 for NS02 series

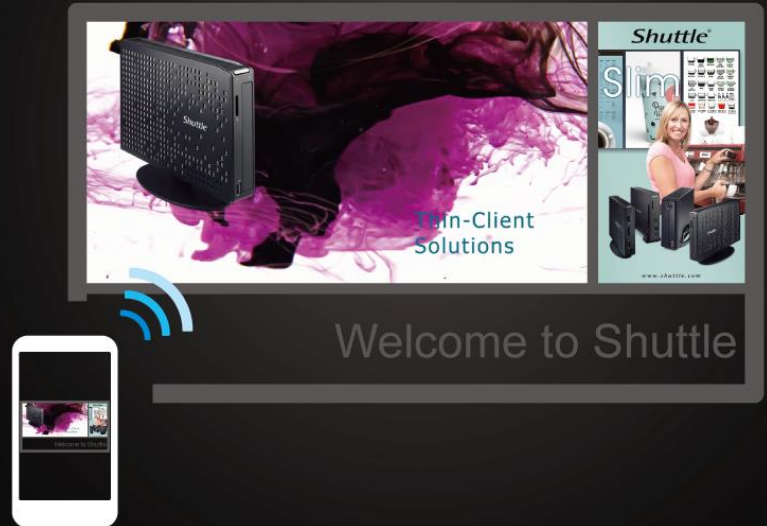

### Introduction



DS Creator 2.0

“DS Creator 2.0” is an application for Shuttle XPC NS02 series. You can use “DS Creator 2.0” on your Android phone or tablet to upload digital signage content such as scrolling text, pictures, videos and webpage links to your digital signage player by following these simple steps.

“DS Creator 2.0” app runs with Android 4.2.X or higher above provided by the manufacturer.

### Preparing for first-time use



DS Connector 2.0

First of all, you need to install the “DS Creator 2.0” app from [Google Play](https://play.google.com/store/apps/details?id=com.shuttle.dscreator) on your Android phone or tablet, then follow the link to install the “DS Connector 2.0” which you need in order to connect to your Shuttle XPC NS02 series.

Second, you need to connect your phone or tablet through in the same local area network (LAN) as the Shuttle XPC NS02 series:

1. On your Android device, select the menu button.
2. Click on Settings and select Wi-Fi.
3. Turn on Wi-Fi then choose the network name.
4. Confirm that your device is connected to the same LAN as your NS02 series.

# Contents

<a href="#"><u>Overview on a client device</u></a>	3
<a href="#"><u>How does it work on a client device</u></a>	4
<a href="#"><u>Type description</u></a>	5
<a href="#"><u>Scrolling Text</u></a>	6
<a href="#"><u>Picture and Video</u></a>	7
<a href="#"><u>Webpage</u></a>	8
<a href="#"><u>Play your project</u></a>	9
<a href="#"><u>Edit your project</u></a>	9
<a href="#"><u>Upload your project to NS02 series</u></a>	10
<a href="#"><u>Overview on the NS02 series</u></a>	11
<a href="#"><u>How does it work on a NS02 series</u></a>	12
<a href="#"><u>Type description</u></a>	13
<a href="#"><u>Scrolling Text</u></a>	14
<a href="#"><u>Picture and Video</u></a>	15
<a href="#"><u>Webpage</u></a>	16
<a href="#"><u>Play your project</u></a>	17
<a href="#"><u>Edit your project</u></a>	17
<a href="#"><u>Set playing schedule on a NS02 series</u></a>	18

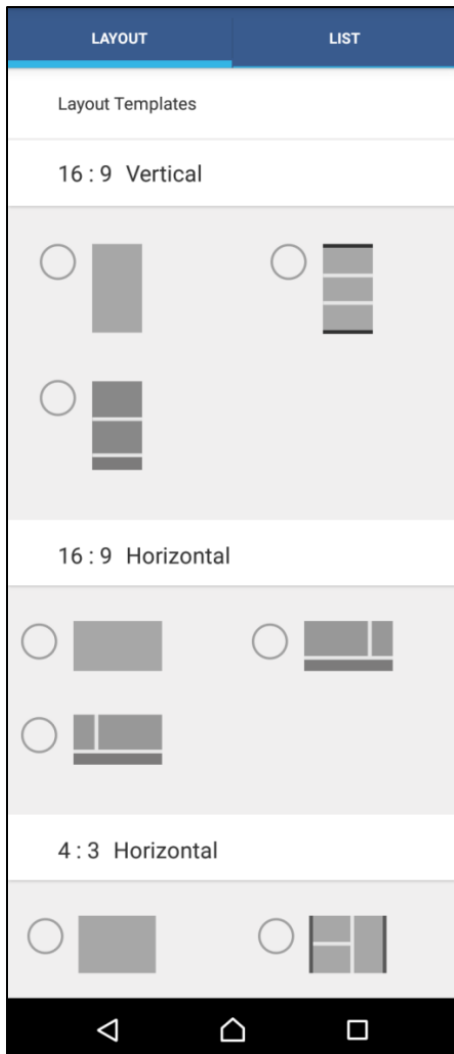

## Overview on a client device

Start the “DS Creator 2.0” app on your Android device. There are 8 types of layout templates for your needs.

### Scrolling Text

- Default size: 48 pt
- Font size: 30-200 pt

### Picture

- Format: JPG, PNG, GIF, BMP

### Video

- Format: MPEG-4, 3GPP

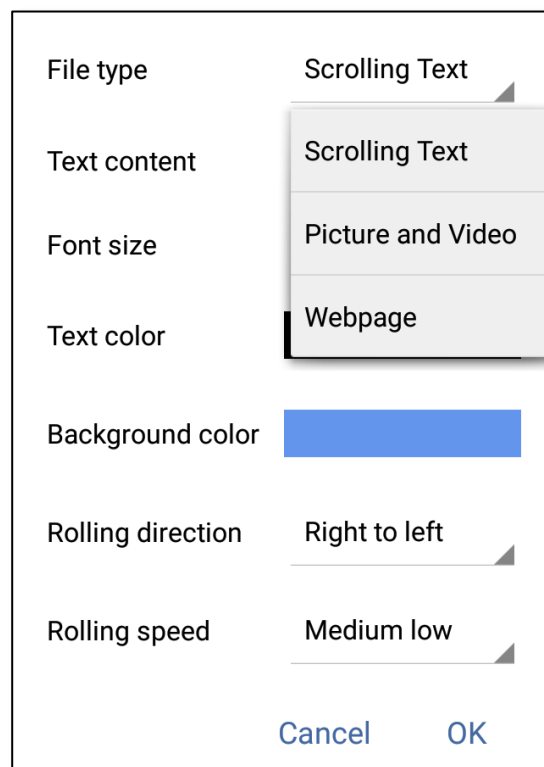
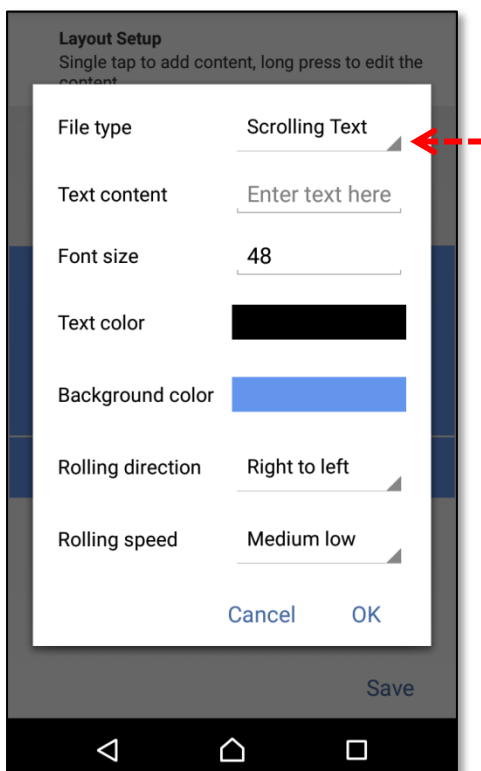

### Webpage

- Recommend: RWD (Responsive Web Design)



## How does it work on a client device?

### Getting Started:



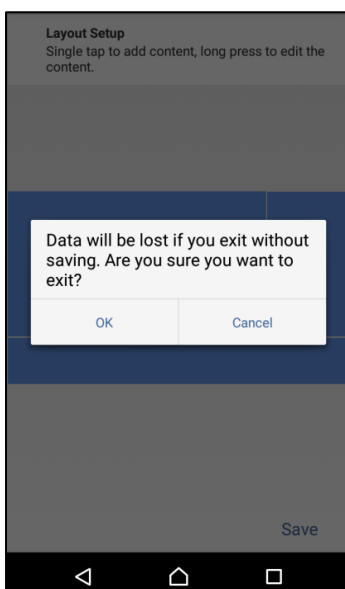
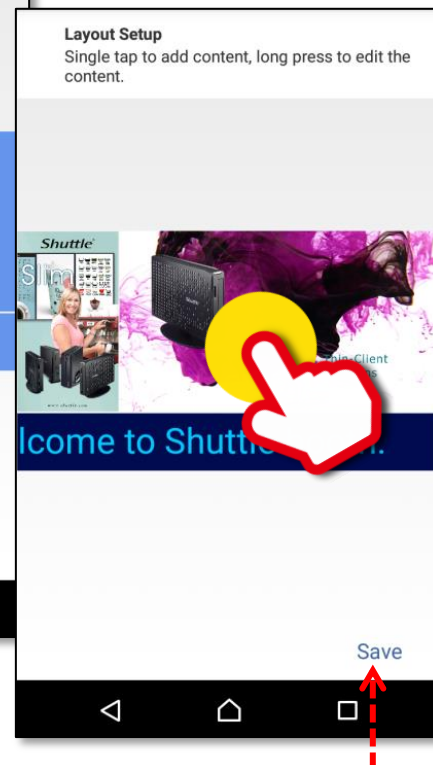
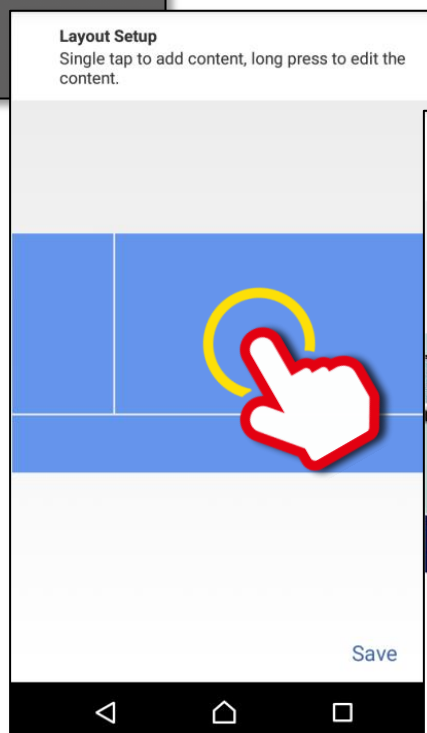
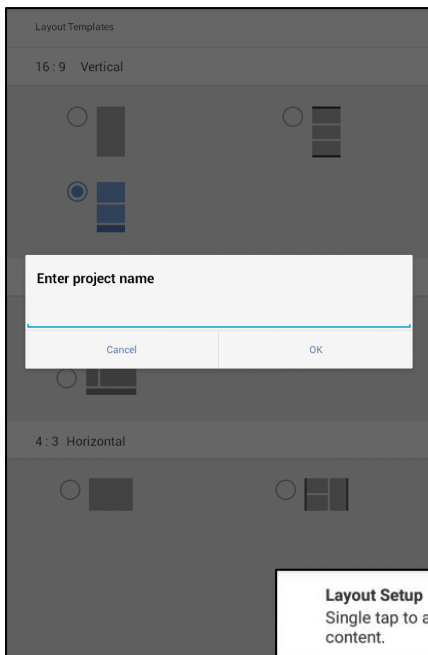



1. Select a layout template for your screen.
  - ◆ Enter project name.
  - ◆ Project name can't be blank.
  - ◆ Special characters ( ' - / , ) are not allowed.
  - ◆ 20 characters maximum.
2. Single tap  to add content and long press  to edit the content.



### Note:

You have to click "Save" button after you build or edit digital signage content.

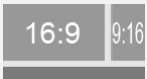
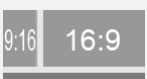
## Type description

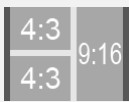
Vertical (9 : 16)			
V1		<b>Picture:</b> 2160x3840px <b>Video:</b> 2160x3840px	Format: JPG, PNG, GIF, BMP Format: MP4, 3GP
V2		<b>Picture:</b> 2160x1215px <b>Video:</b> 2160x1215px	Format: JPG, PNG, GIF, BMP Format: MP4, 3GP
V3		<b>Picture:</b> 2160x1620px <b>Video:</b> 2160x1620px <b>Scrolling Text:</b> Default: 48 pt	Format: JPG, PNG, GIF, BMP Format: MP4, 3GP Font size: 30-200 pt
Horizontal (16 : 9)			
H1		<b>Picture:</b> 3840x2160px <b>Video:</b> 3840x2160px	Format: JPG, PNG, GIF, BMP Format: MP4, 3GP
H2		<b>Picture:</b> 2560x1440px(16:9); 1440x2560px(9:16) <b>Video:</b> 2560x1440px(16:9); 1440x2560px(9:16) <b>Scrolling Text:</b> Default: 48 pt	Format: JPG, PNG, GIF, BMP Format: MP4, 3GP Font size: 30-200 pt
H3		<b>Picture:</b> 1440x2560px(9:16); 2560x1440px(16:9) <b>Video:</b> 1440x2560px(9:16); 2560x1440px(16:9) <b>Scrolling Text:</b> Default: 48 pt	Format: JPG, PNG, GIF, BMP Format: MP4, 3GP Font size: 30-200 pt
Horizontal (4 : 3)			
H4		<b>Picture:</b> 3840x1440px <b>Video:</b> 3840x1440px	Format: JPG, PNG, GIF, BMP Format: MP4, 3GP
H5		<b>Picture:</b> 2560x1920px(4:3); 1440x2560px(9:16) <b>Video:</b> 2560x1920px(4:3); 1440x2560px(9:16)	Format: JPG, PNG, GIF, BMP Format: MP4, 3GP

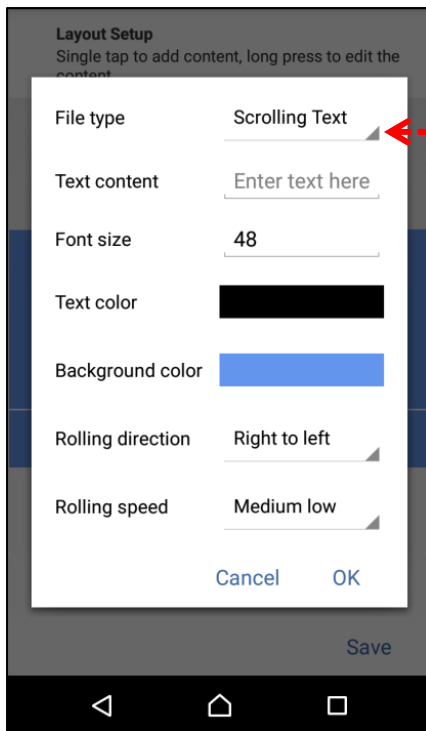

## Scrolling Text

### Steps:

1. Click "File type".
2. Choose "Scrolling Text"
3. Enter text content (150 characters maximum).
4. Choose font size (30-200 pt).
5. Choose a text color.
6. Choose a background color.
7. Set text rolling direction.
8. Set text rolling speed.
9. Press "OK" to finish.

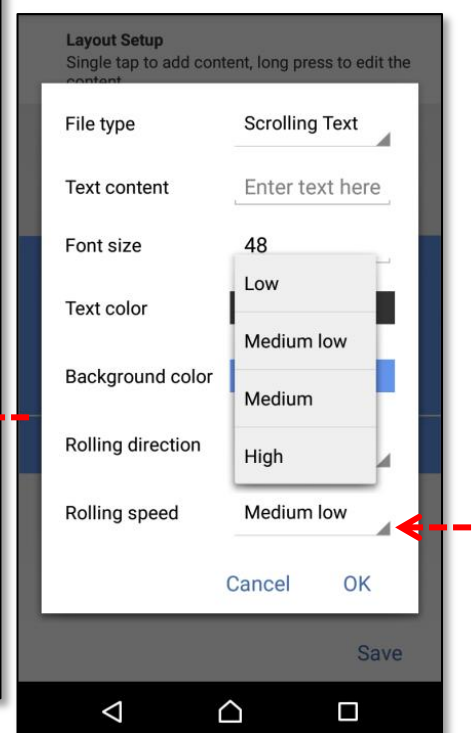
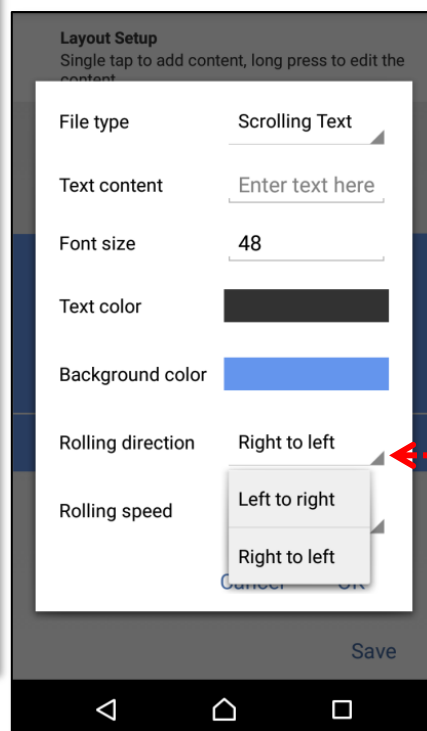
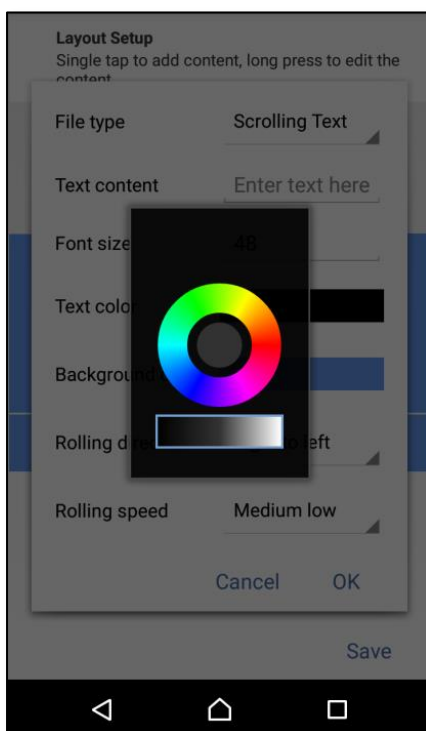

### Note:

After choosing a color, click the circle button.

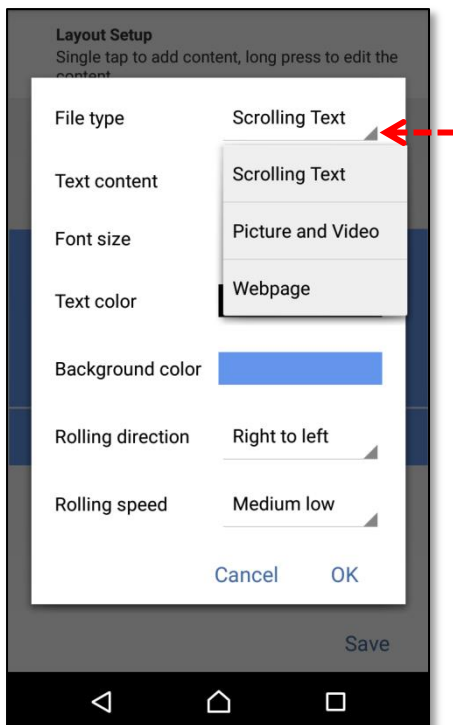

## Picture and Video

### Steps:

1. Click "File type".
2. Choose "Picture and Video".
3. Add pictures or videos (10 items maximum).
4. Set items' effects.
5. Set items' switching speed.
6. Press "OK" to finish.

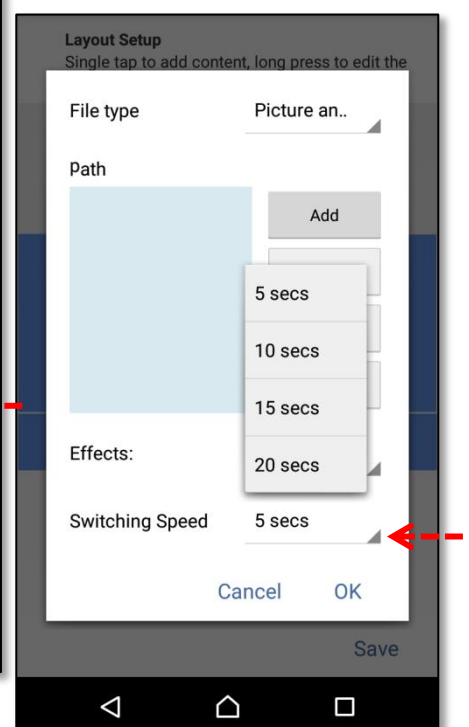
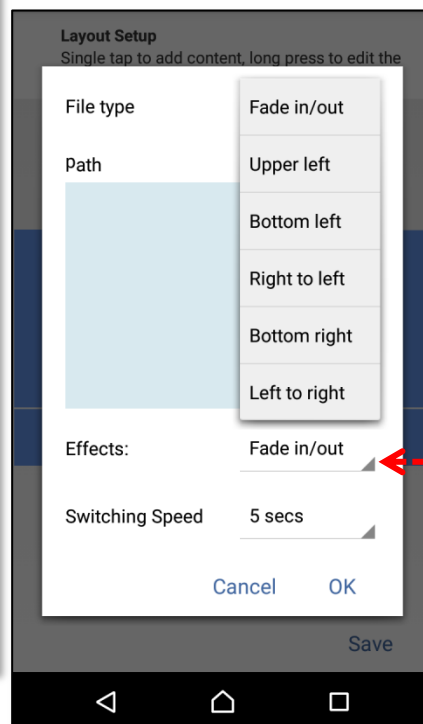
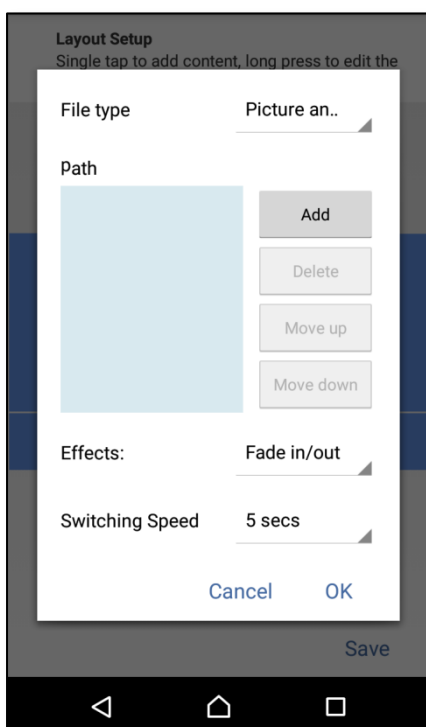

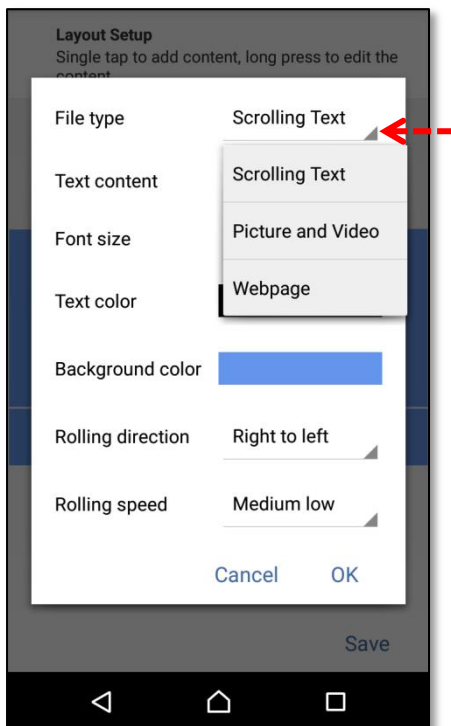

## Webpage

### Steps:

1. Click "File type".
2. Choose "Webpage".
3. Input "Webpage link".
4. Press "OK" to finish.

### Note:

Recommend: RWD (Responsive Web Design)

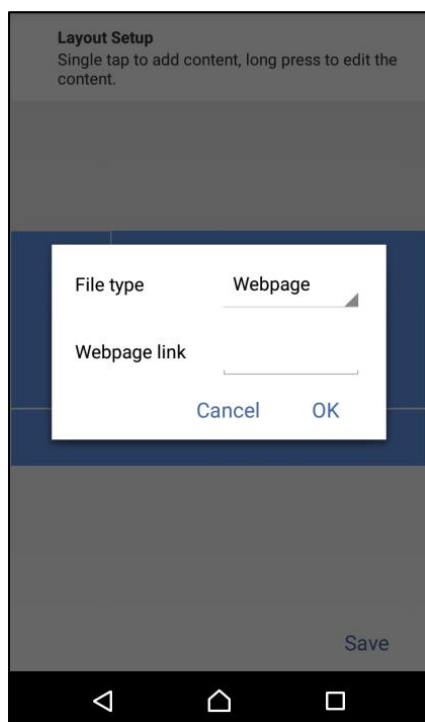



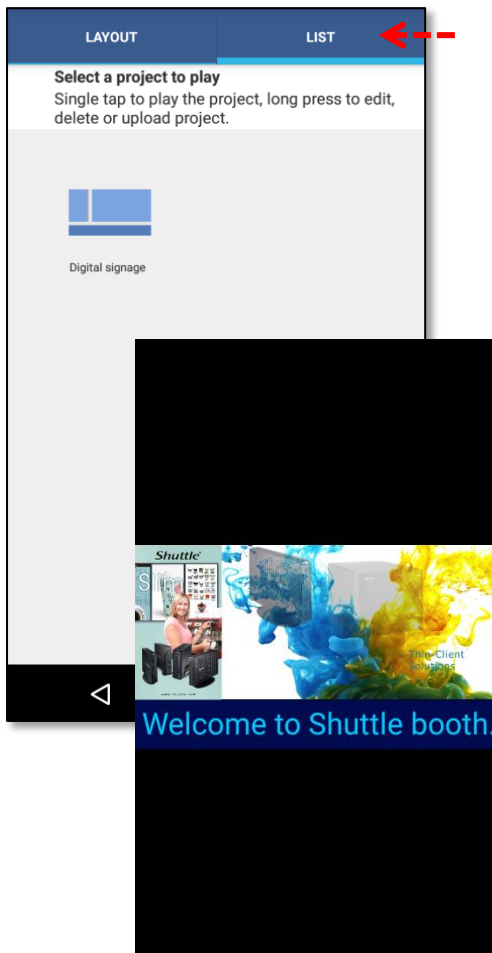



## Play your project

### Steps:

1. Click "List".
2. Tap  the project.  
The project will be played for only 30 seconds.

## Edit your project

### Steps:

1. Click "List".
2. Long press  the project.
3. Choose "Edit".  
Original content will be kept until modify.
4. Press "OK" to finish.

## Edit your project

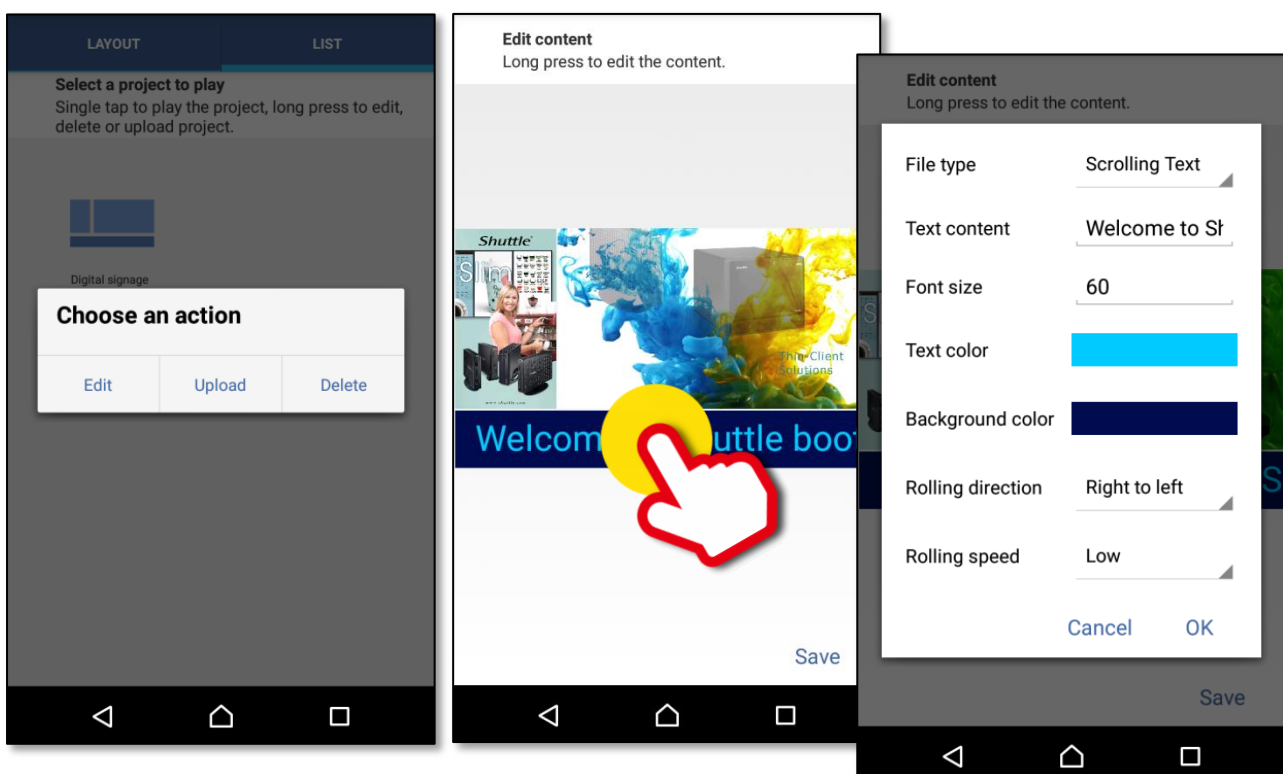

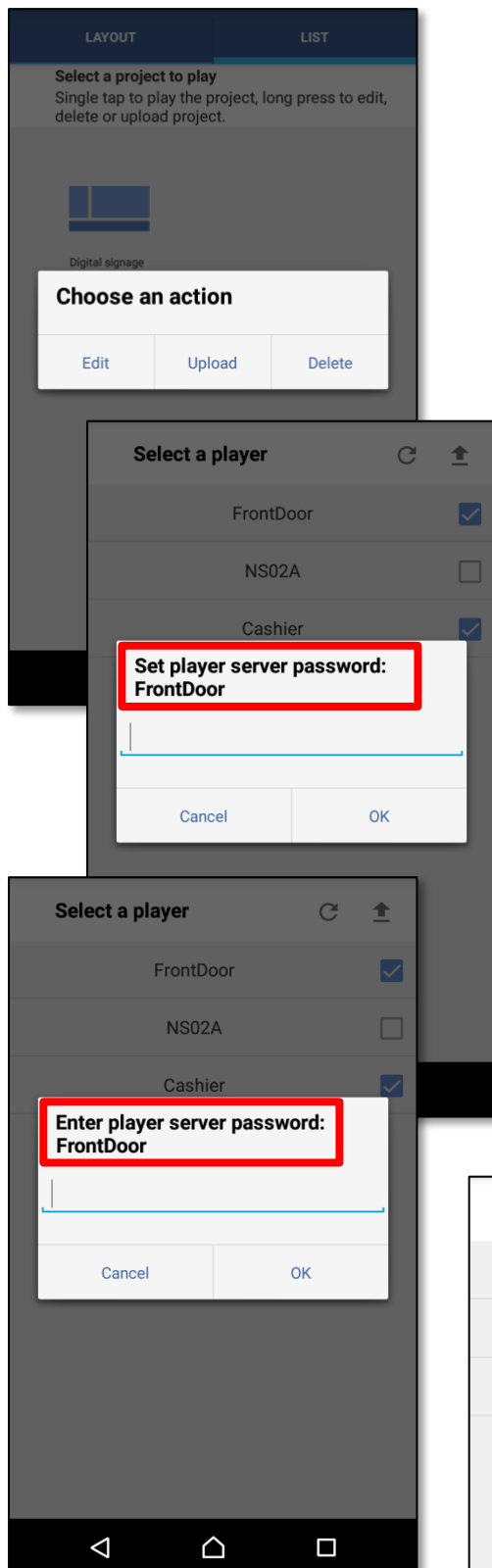

## Upload your project to NS02 series

### Steps:

1. Tap "List" on your device.
2. Long press the project.
3. Tap the "Upload" button.
4. Choose the server(s).
5. Tap the  Upload icon
6. Set player server password.
  - ◆ The first time connect to server.
  - ◆ 8 characters maximum.
7. Enter player server password.
  - ◆ After setting the password.
8. Press "OK" to upload.

### Note:

Tap server to modify the name.

- ◆ 20 characters maximum.
- ◆ Special characters ( ' - / , ) are not allowed.

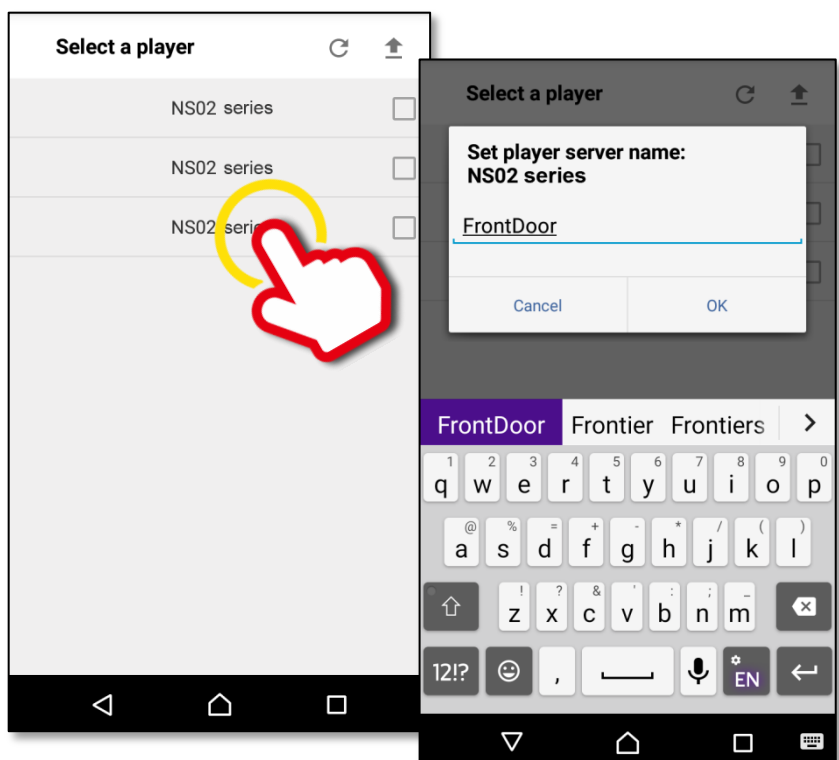

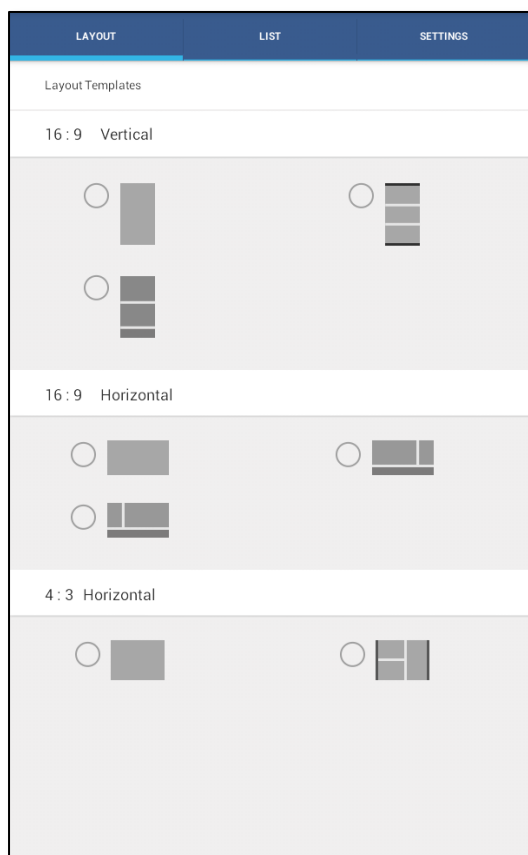

## Overview on the NS02 series

Start the “DS Creator 2.0” app on your NS02 series. There are 8 types of layout templates for your needs.

### Scrolling Text

- Default size: 48 pt
- Font size: 30-200 pt

### Picture

- Format: JPG, PNG, GIF, BMP

### Video

- Format: MPEG-4, 3GPP

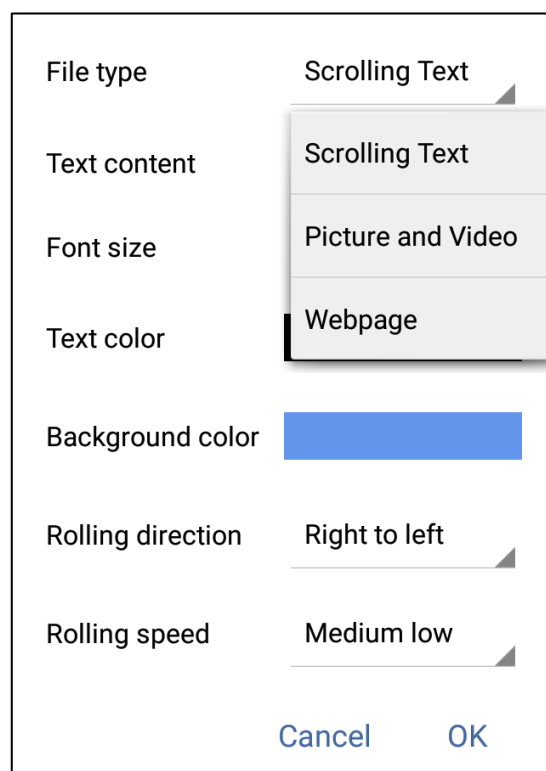
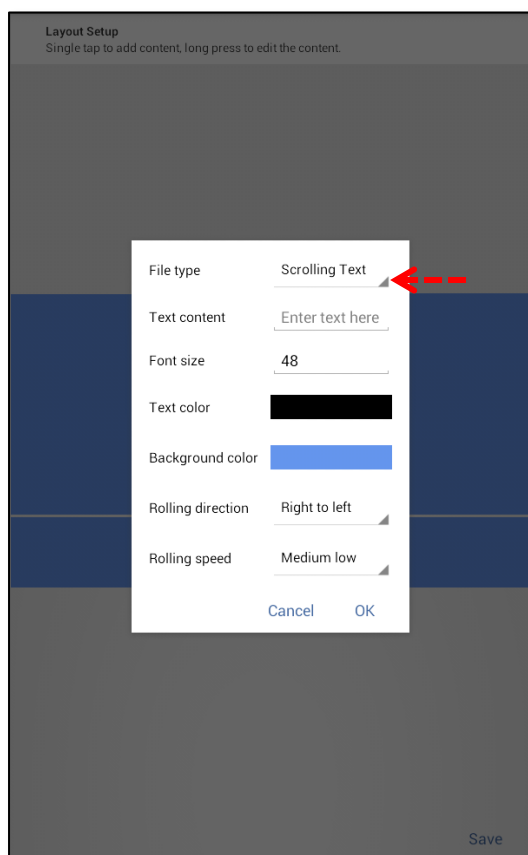

### Webpage

- Recommend: RWD(Responsive Web Design)



## How does it work on a NS02 series?

### Getting Started:



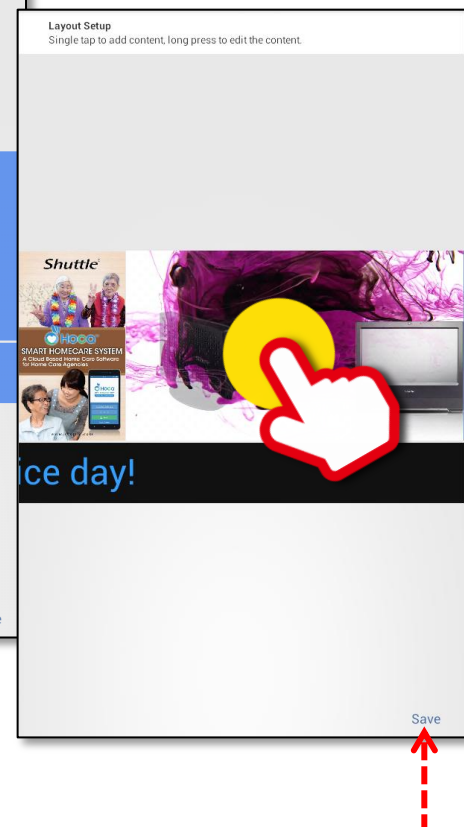
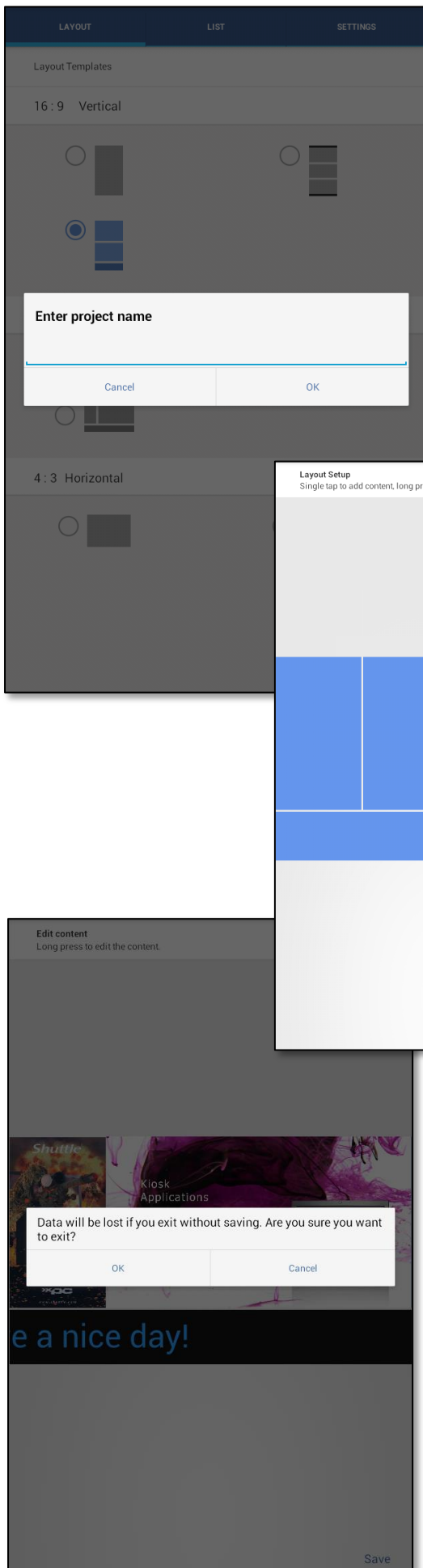



1. Select a layout template for your screen.
  - ◆ Enter project name.
  - ◆ Project name can't be blank.
  - ◆ Special characters ( ' - / , ) are not allowed.
  - ◆ 20 characters maximum.
2. Single tap  to add content and long press  to edit the content.



### Note:

You have to click “Save” button after you build or edit digital signage content.

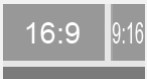
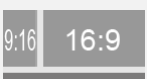
## Type description

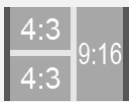
Vertical (9 : 16)			
V1		<b>Picture:</b> 2160x3840px <b>Video:</b> 2160x3840px	Format: JPG, PNG, GIF, BMP Format: MP4, 3GP
V2		<b>Picture:</b> 2160x1215px <b>Video:</b> 2160x1215px	Format: JPG, PNG, GIF, BMP Format: MP4, 3GP
V3		<b>Picture:</b> 2160x1620px <b>Video:</b> 2160x1620px <b>Scrolling Text:</b> Default: 48 pt	Format: JPG, PNG, GIF, BMP Format: MP4, 3GP Font size: 30-200 pt
Horizontal (16 : 9)			
H1		<b>Picture:</b> 3840x2160px <b>Video:</b> 3840x2160px	Format: JPG, PNG, GIF, BMP Format: MP4, 3GP
H2		<b>Picture:</b> 2560x1440px(16:9); 1440x2560px(9:16) <b>Video:</b> 2560x1440px(16:9); 1440x2560px(9:16) <b>Scrolling Text:</b> Default: 48 pt	Format: JPG, PNG, GIF, BMP Format: MP4, 3GP Font size: 30-200 pt
H3		<b>Picture:</b> 1440x2560px(9:16); 2560x1440px(16:9) <b>Video:</b> 1440x2560px(9:16); 2560x1440px(16:9) <b>Scrolling Text:</b> Default: 48 pt	Format: JPG, PNG, GIF, BMP Format: MP4, 3GP Font size: 30-200 pt
Horizontal (4 : 3)			
H4		<b>Picture:</b> 3840x1440px <b>Video:</b> 3840x1440px	Format: JPG, PNG, GIF, BMP Format: MP4, 3GP
H5		<b>Picture:</b> 2560x1920px(4:3); 1440x2560px(9:16) <b>Video:</b> 2560x1920px(4:3); 1440x2560px(9:16)	Format: JPG, PNG, GIF, BMP Format: MP4, 3GP

## Scrolling Text

### Steps:

1. Click "File type".
2. Choose "Scrolling Text"
3. Enter text content (150 characters maximum).
4. Choose font size (30-200 pt).
5. Choose a text color.
6. Choose a background color.
7. Set text rolling direction.
8. Set text rolling speed.
9. Press "OK" to finish.

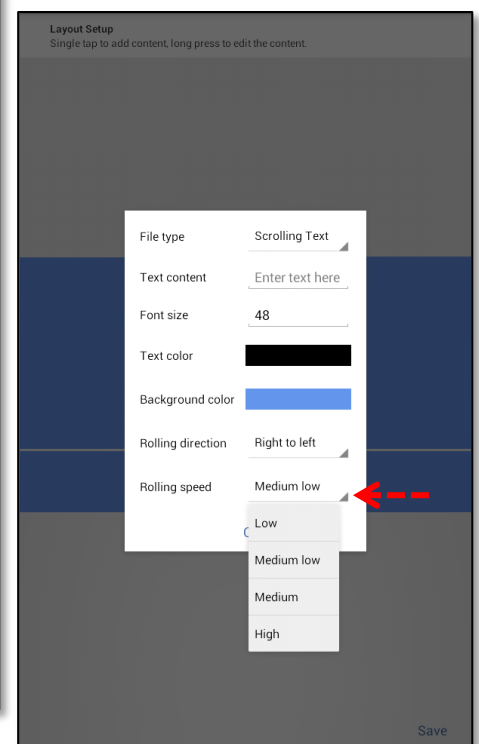
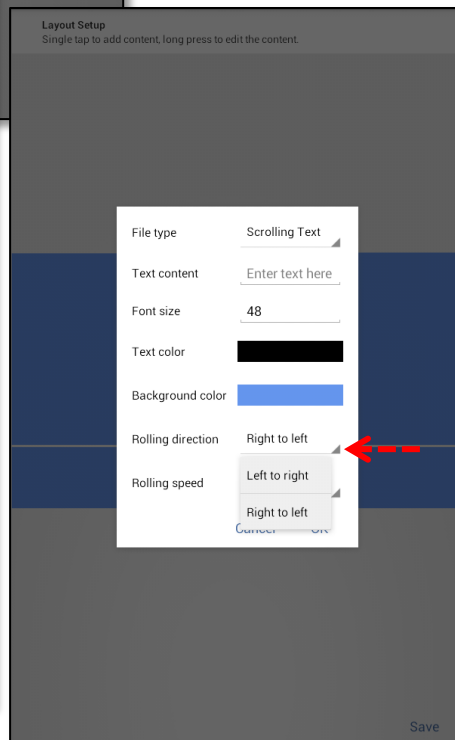
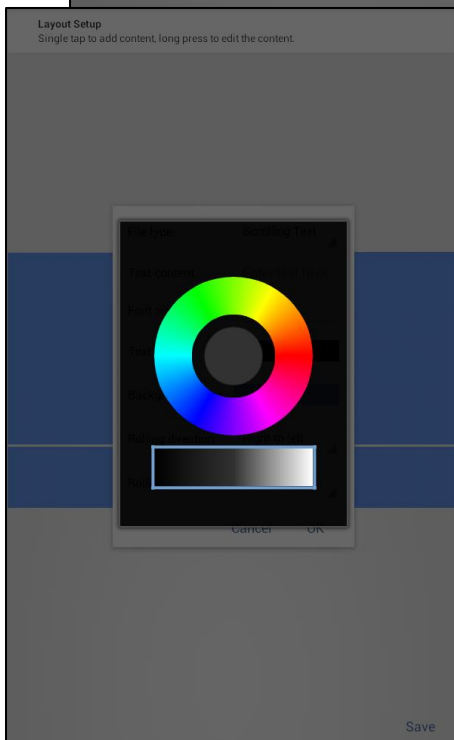
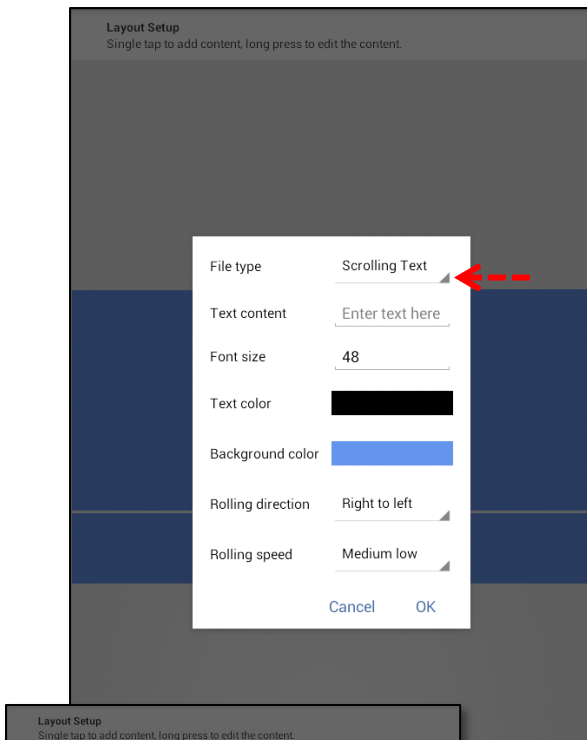

### Note:

After choosing a color, click the circle button.

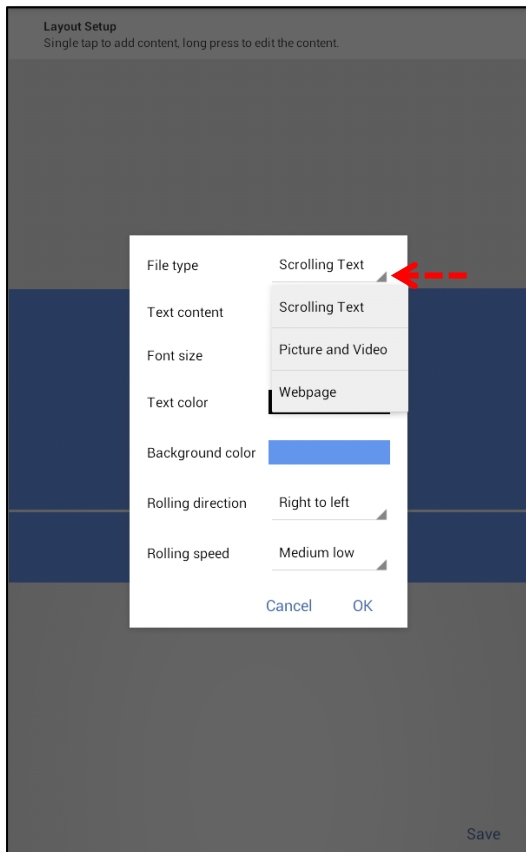

## Picture and Video

### Steps:

1. Click "File type".
2. Choose "Picture and Video".
3. Add pictures or videos (10 items maximum).
4. Set items' effects.
5. Set items' switching speed.
6. Press "OK" to finish.

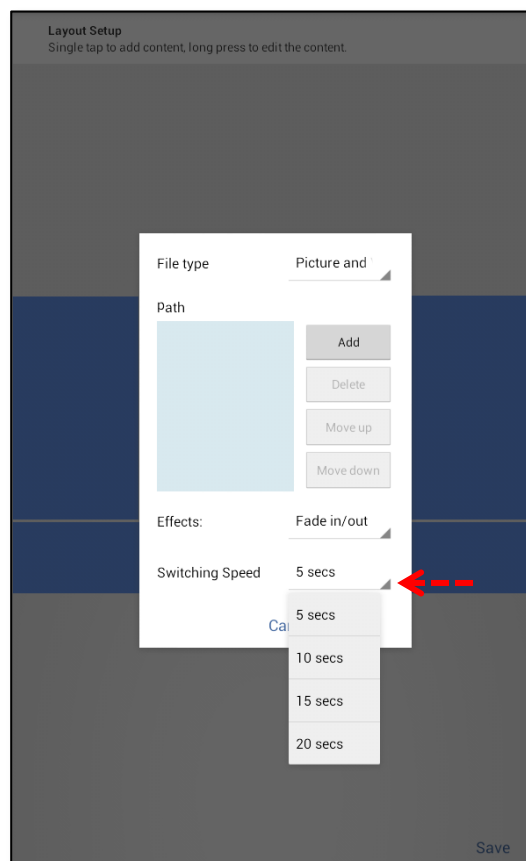
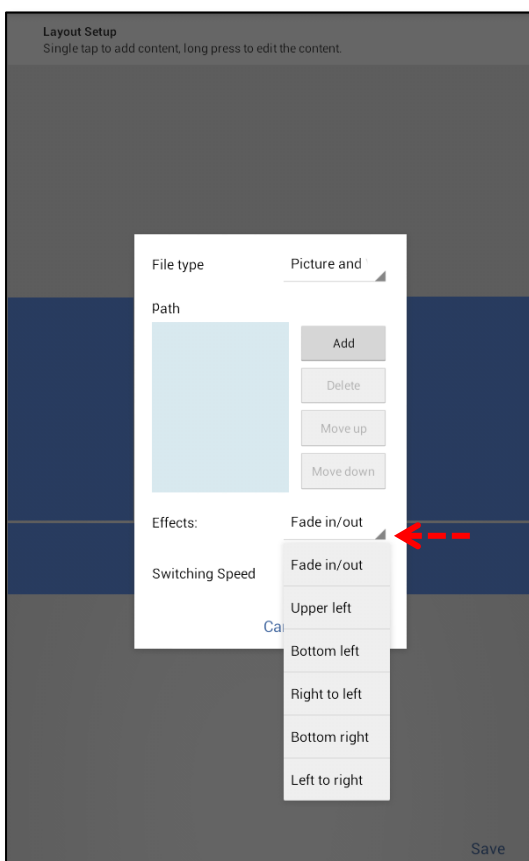

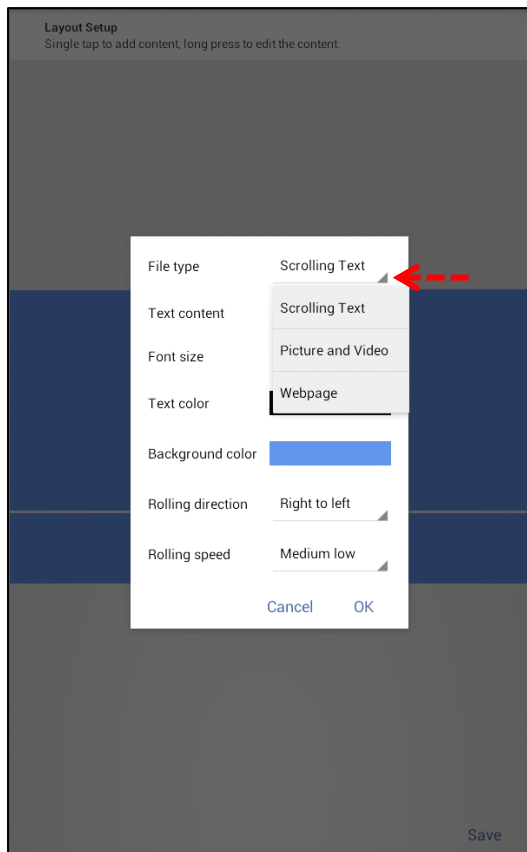

## Webpage

### Steps:

1. Click "File type".
2. Choose "Webpage".
3. Input "Webpage link".
4. Press "OK" to finish.

### Note:

Recommend: RWD (Responsive Web Design)

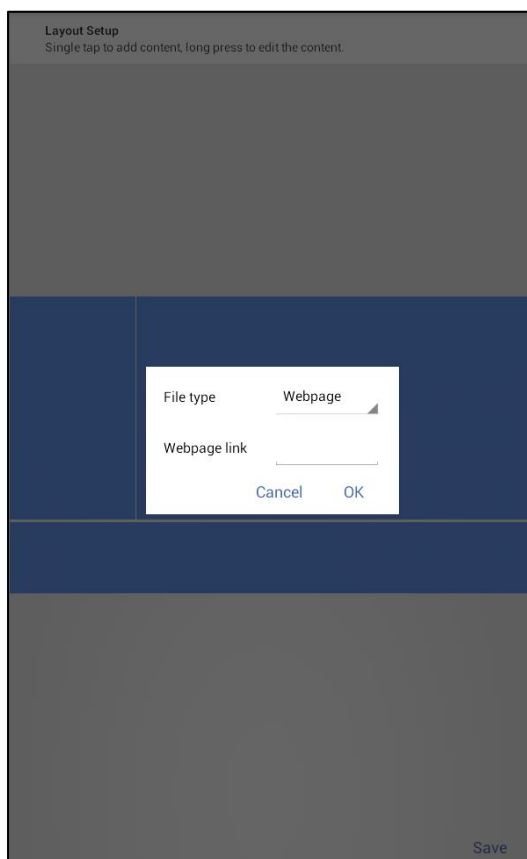



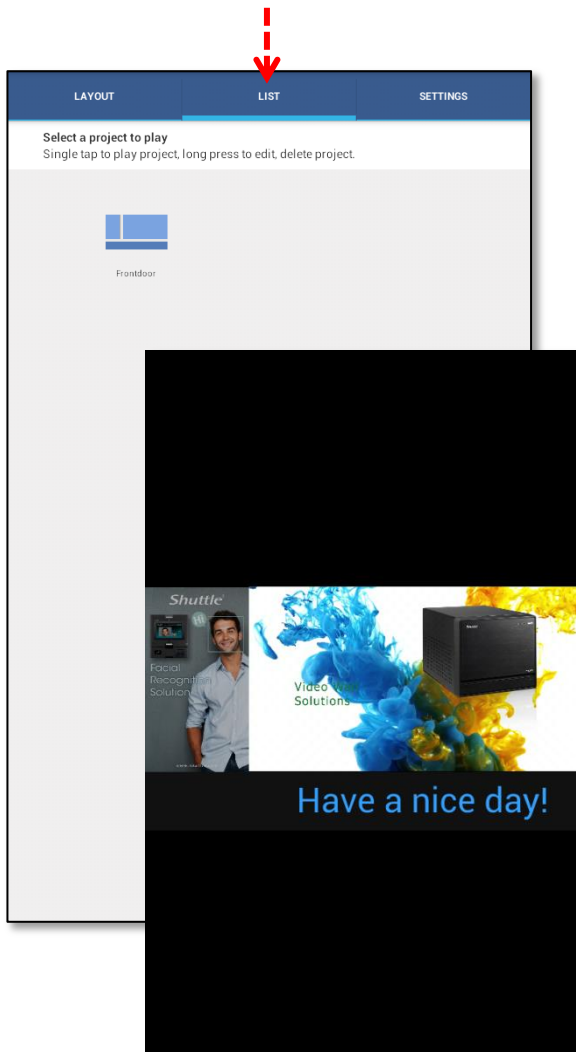



## Play your project

### Steps:

1. Click "List".
2. Tap  the project.  
The project will be played until the server enters standby mode.

## Edit your project

### Steps:

1. Click "List".
2. Long press  the project.
3. Choose "Edit".  
Original content will be kept until modify.

## Edit your project

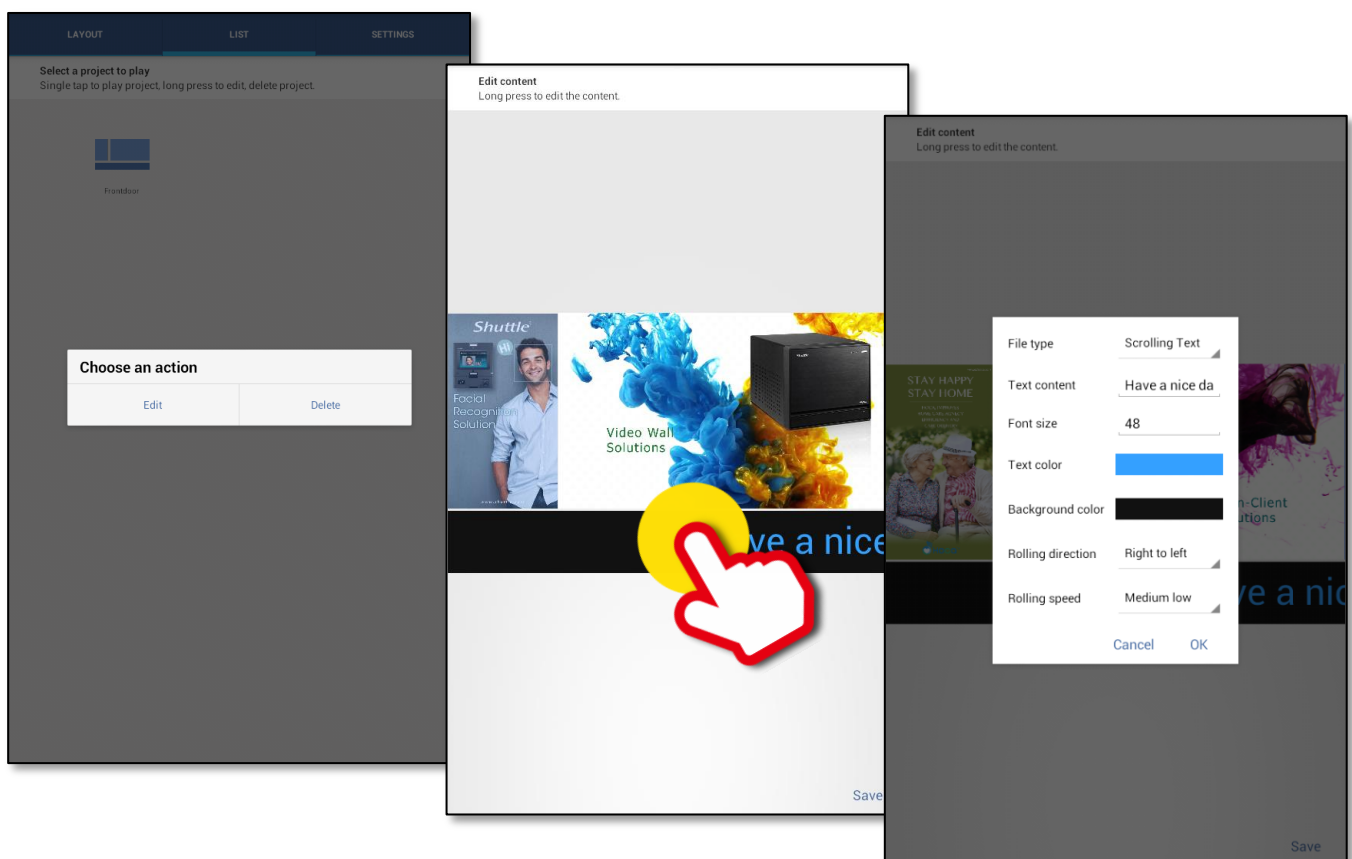

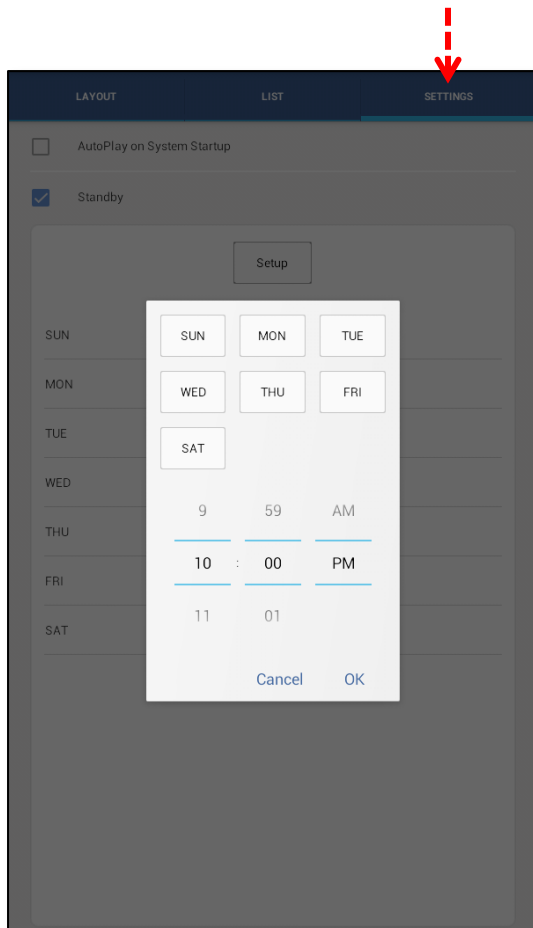

## Set playing schedule on a NS02 series

The last project that you upload from your device (client) will be played until you upload another project or the server enters standby mode.

### Steps:

1. Tap "SETTINGS".
2. Check "AutoPlay on System Startup".  
◆ NS02 series will auto play the latest project after system startup.
3. Check "Standby".
4. Set Weekdays and time.
5. Press "OK" to finish.

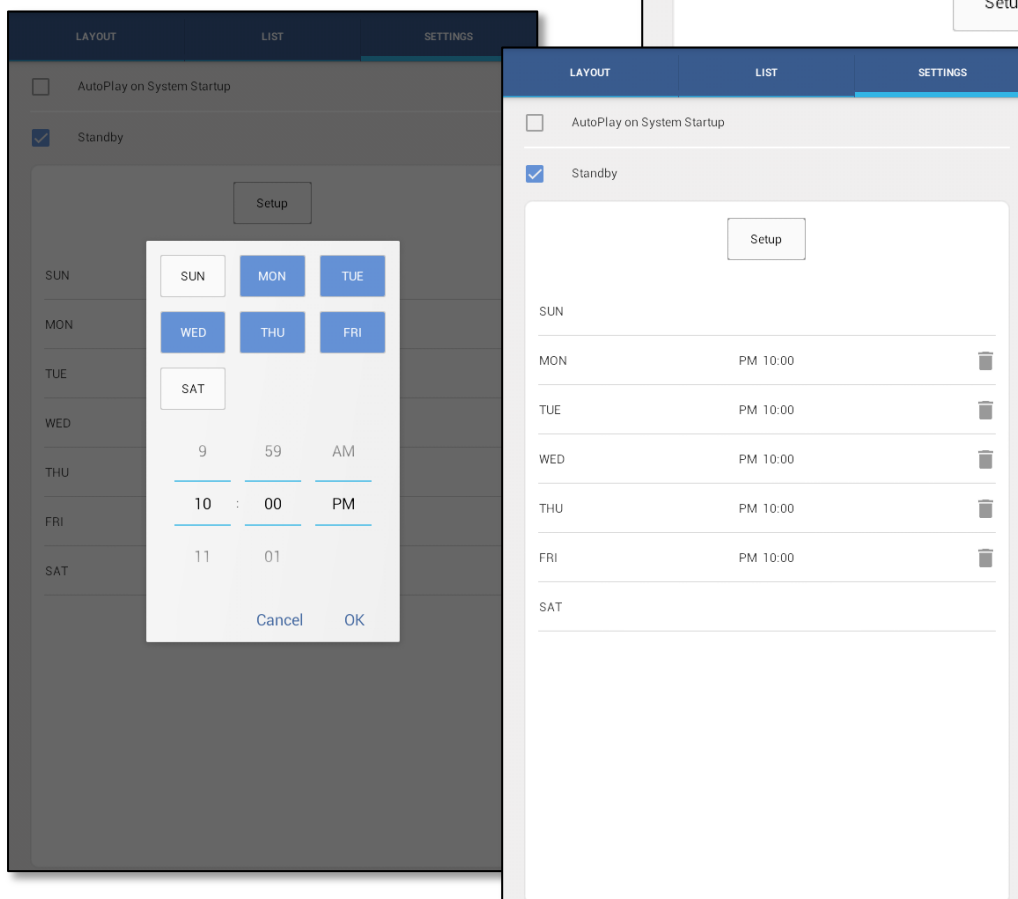
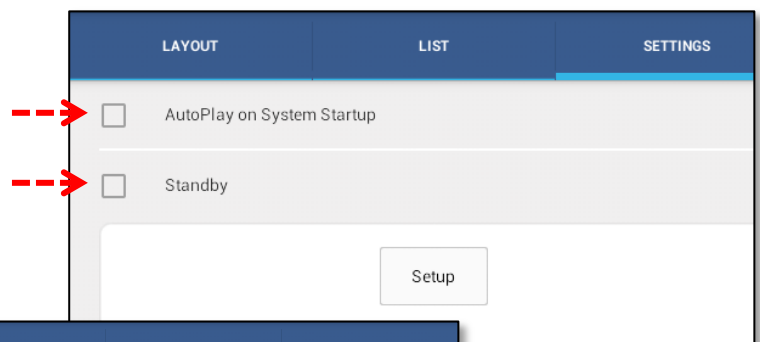



## **Shuttle Inc.**

<http://global.shuttle.com>

Department E-mail Contacts:

Sales: [sales@tw.shuttle.com](mailto:sales@tw.shuttle.com)

Technical Support E-mail: [support@tw.shuttle.com](mailto:support@tw.shuttle.com)

Media Contact: [shuttlepr@tw.shuttle.com](mailto:shuttlepr@tw.shuttle.com)